

# MOLD MAKING

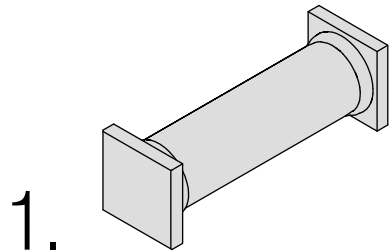

The desired form is CNC'd out of foam.

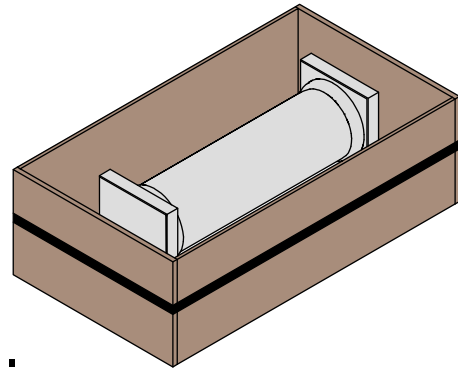

The foam is then placed into a plywood box, held together with a strap.

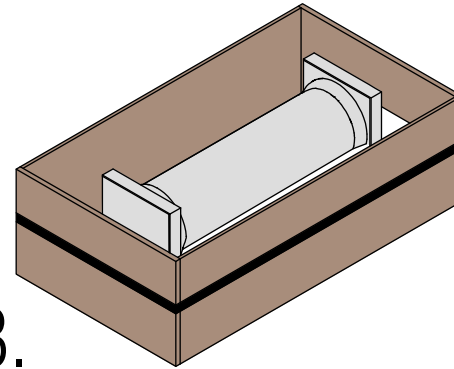

A quarter of the box is blocked off with either clay or a 3D printed piece to fit. Plaster is then poured into this section.

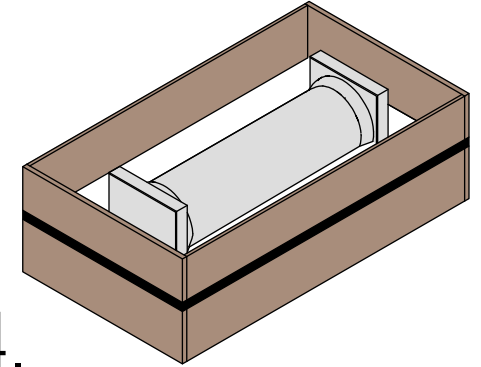

Holes can be drilled into the plaster after it has dried. Then step 3 is repeated on the other side after applying vaseline to prevent sticking.

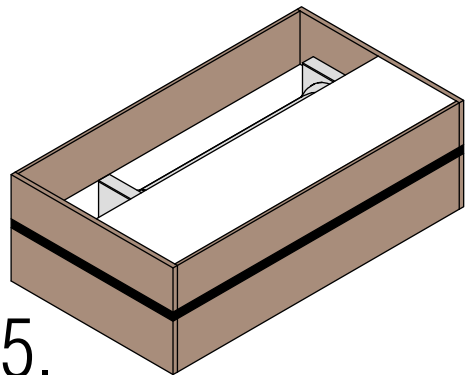

Repeat steps 3 and 4 for the top half. The plaster will be poured into the drilled holes and create a key-like fit when reusing the mold.

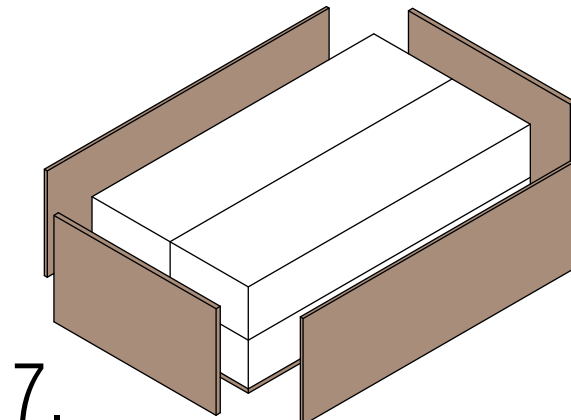
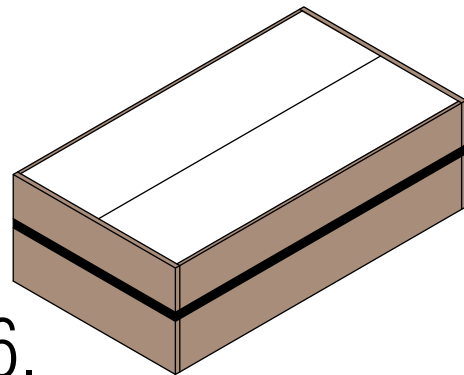

Once everything is dry, the plywood can be taken apart to prepare to separate the plaster.

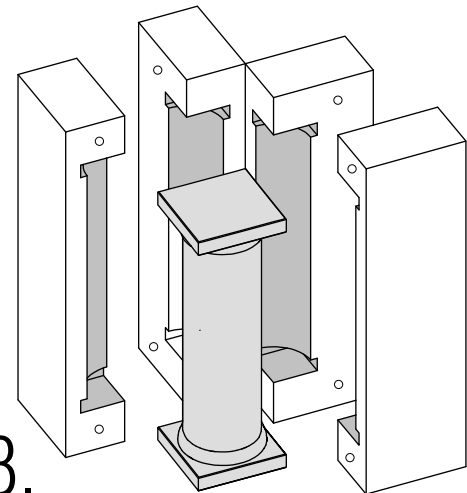

The plaster is then split apart to reveal the final mold.